

AGRICULTURAL CERAMICS THROUGH COMMUNITY INVOLVEMENT & SKILL-BUILDING



Community Growing



Colette Bazirgan

MATERIAL EXPLORATION

**GLASS
& RICE HULL**



**CERAMIC
& RICE HULL**



**CERAMIC
& RICE STRAW**



**CERAMIC
& SUGAR CANE**



**CERAMIC
& RICE HULL**



CONCERN



LOST CRAFT CULTURE

CLAY

Guaitil Pottery Studio makes and sells traditional Chorotega pottery. Pottery lessons are also available.



Tamarindo

Guaitil

Descendents of the Chorotega Indians live here, preserving the traditional pottery techniques of their ancestors.

La Flor

Liberia

Santa Elena

CHOROTEGA

in Costa Rica

Guacimo

San Jose

CASEM co-op is located here. It is an opportunity for artisans to turn their art into business. It is a group of 100 members, mostly women.

making the clay

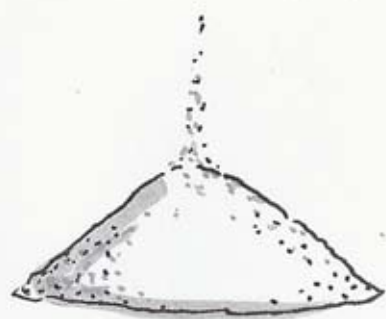

sand



soil



water



stomp



MATERIAL PROCESS



MATERIAL PROCESS





WHAT EARTH STUDENTS ARE DOING NOW

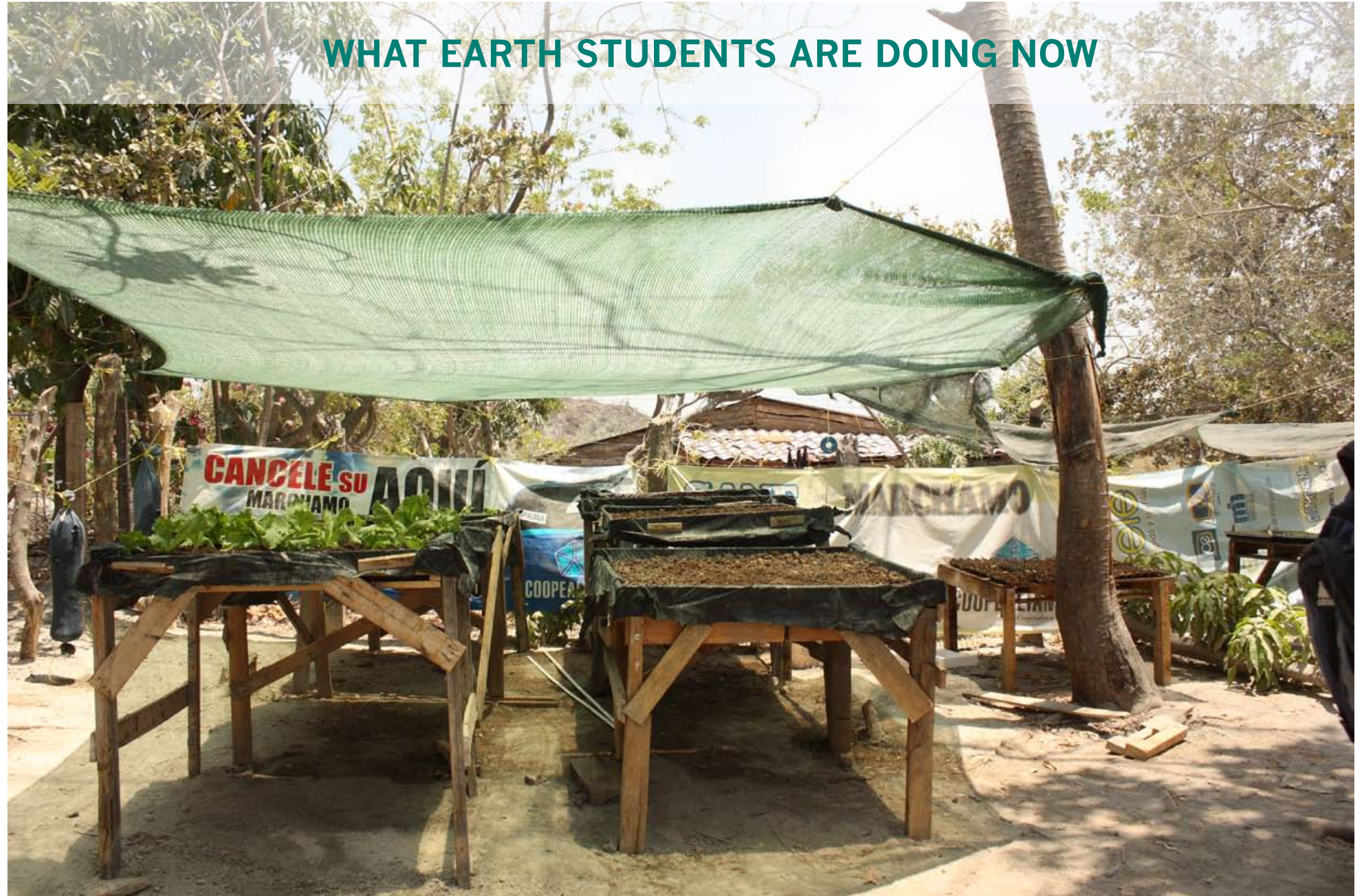

MATERIAL PROPOSAL



MATERIAL BENEFITS

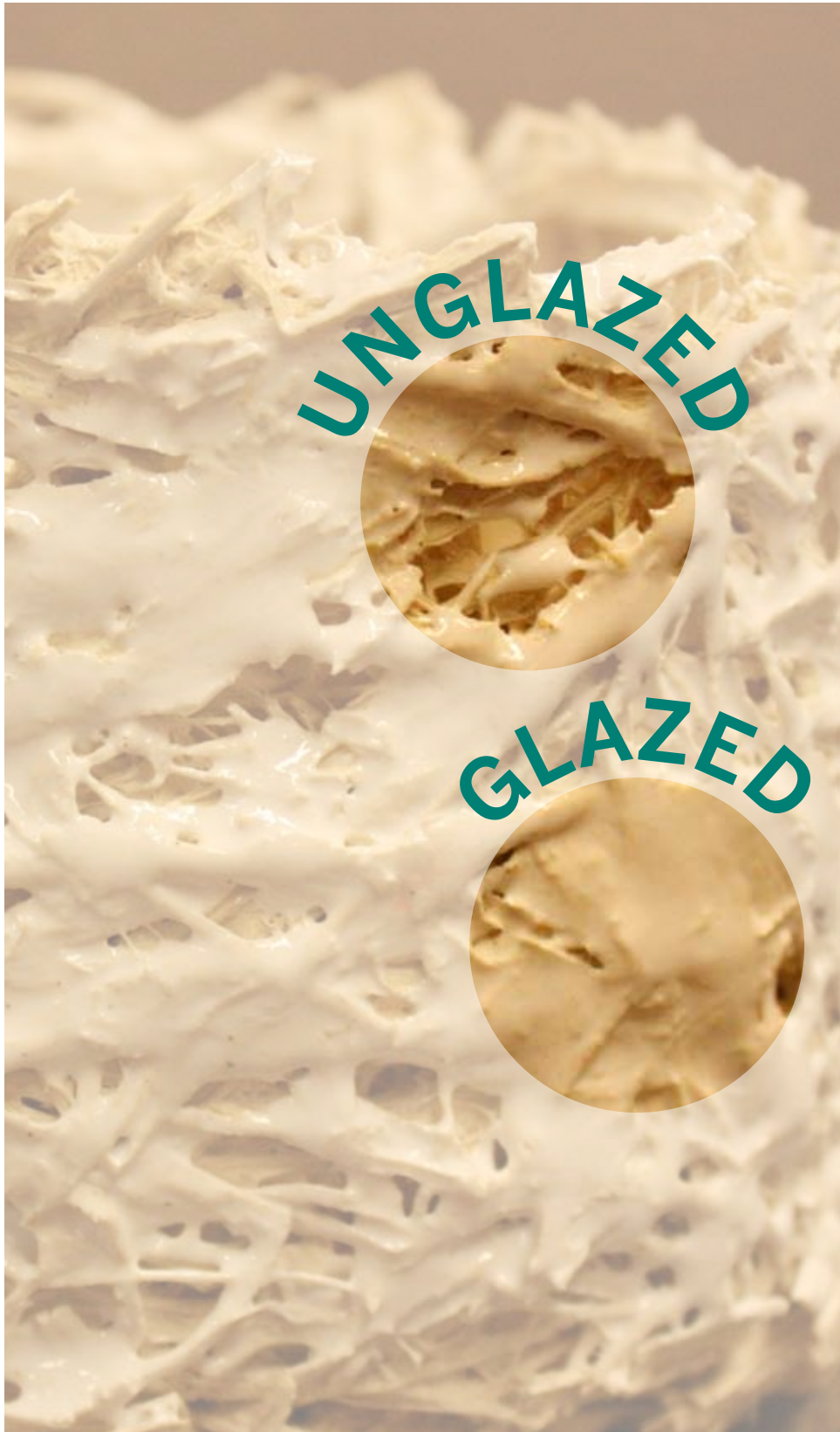

WATER ABSORBANT
The center of the material is unglazed and therefore retains water acting as a wicking material and a natural cooling system.

WATERPROOF
The glaze strengthens the material and waterproofs the surfaces.

GROWING MEDIUM
The soil is contained in the mesh allowing the roots to grow through the porous material.

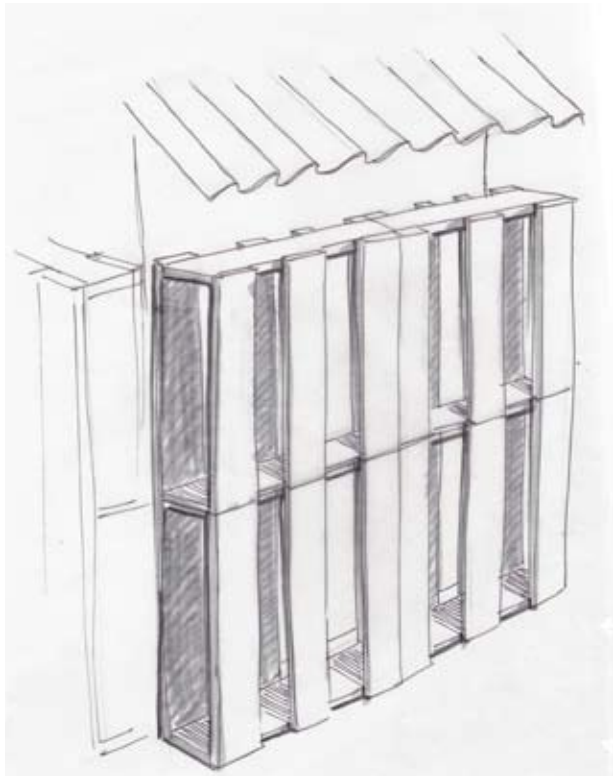

KILN / OVEN

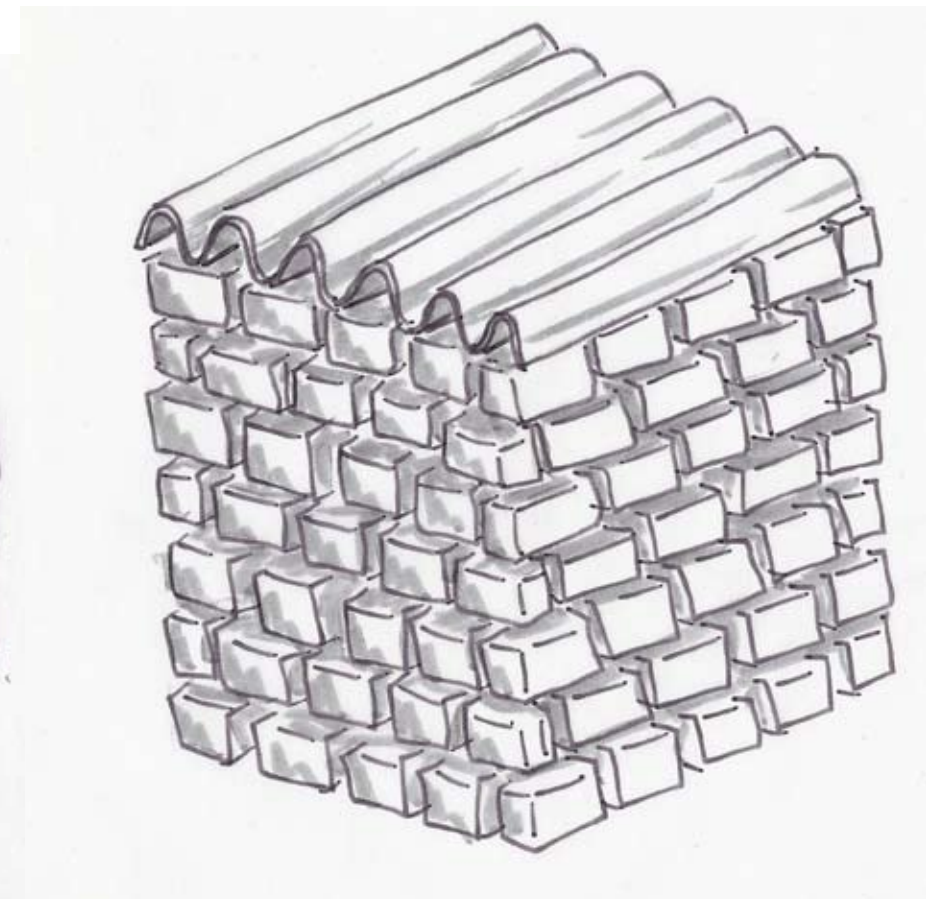
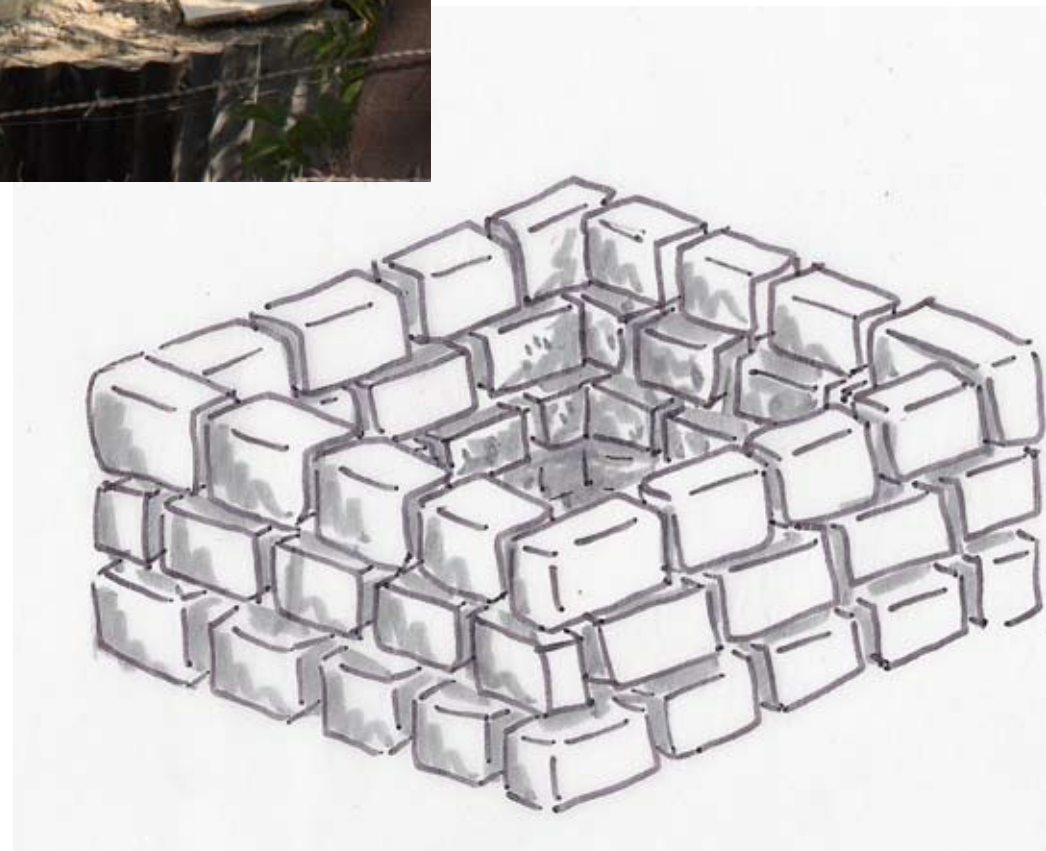
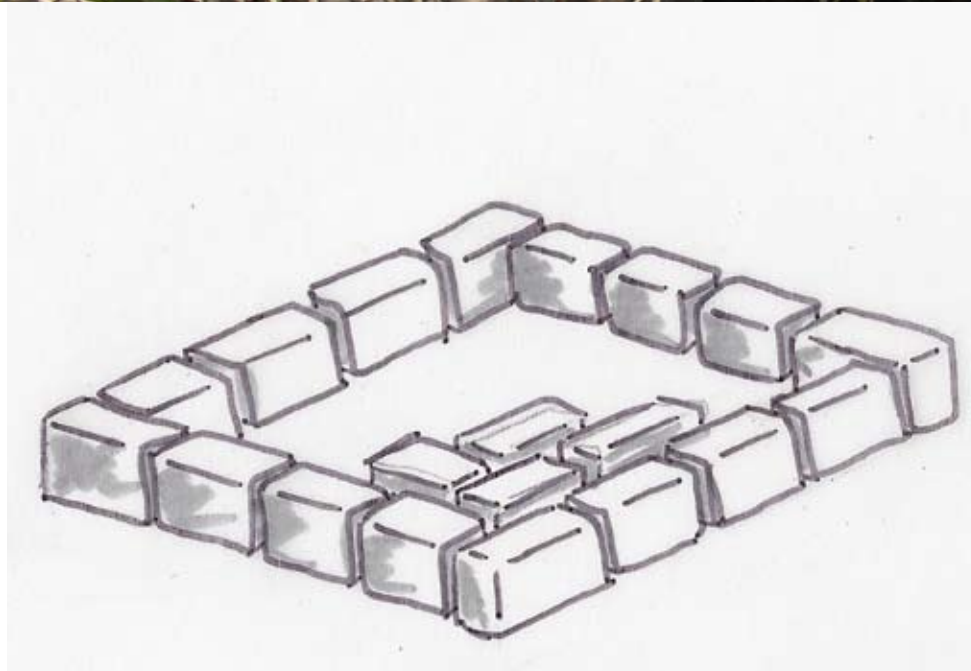
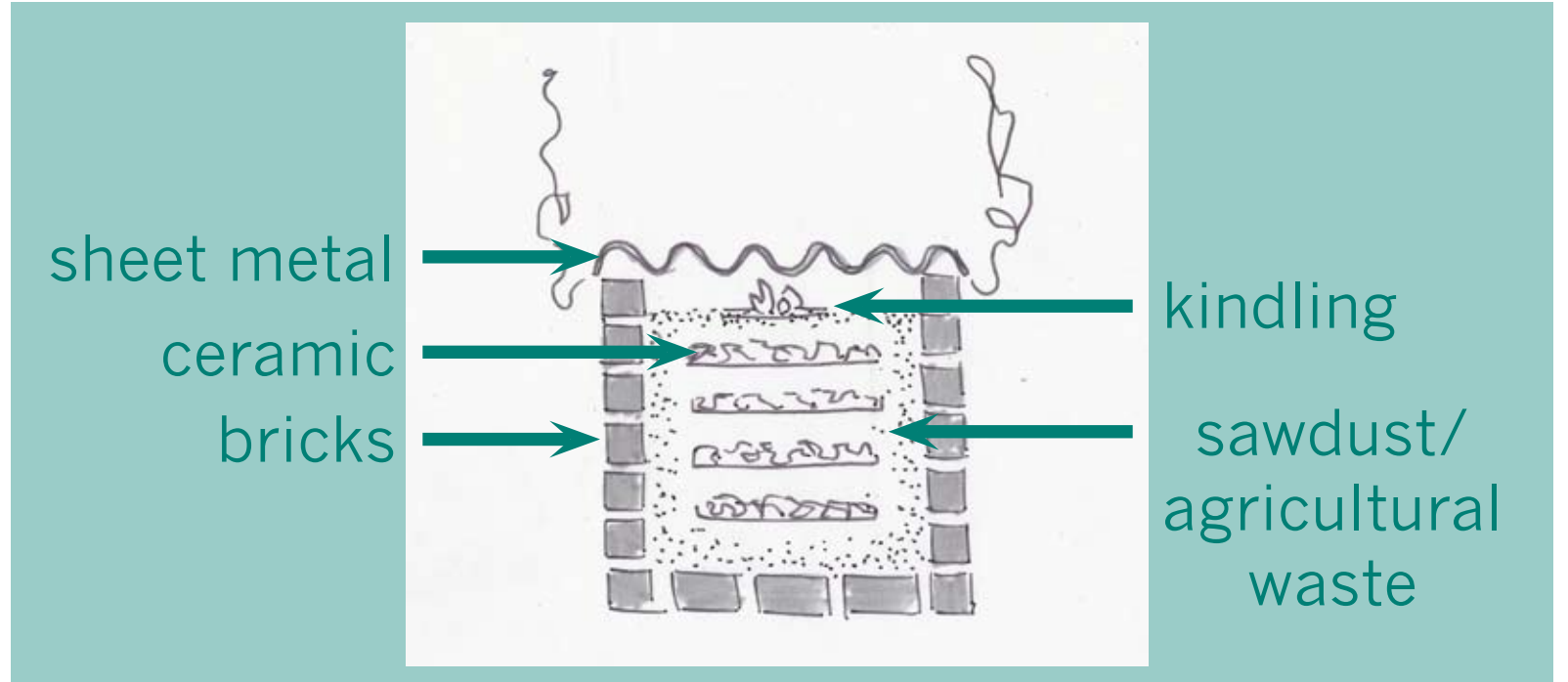

COMMUNITY SPACE



Community Growing

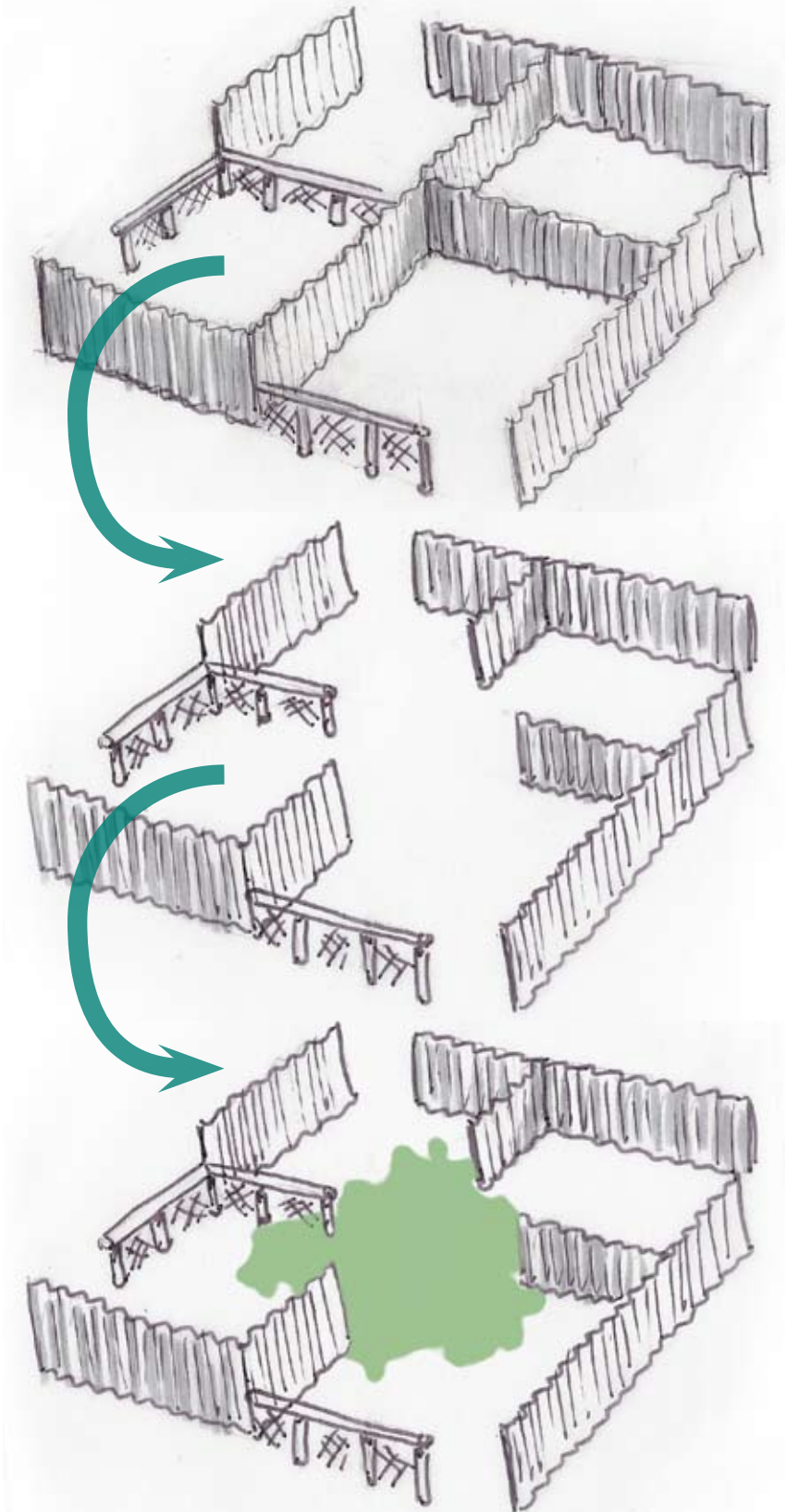

Colette Bazirgan

CERAMIC GROWING MEDIUM

SUPPLIES



rice straw



clay

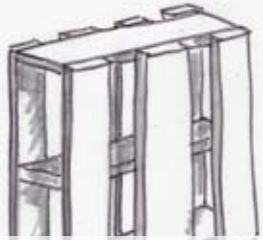

pallets

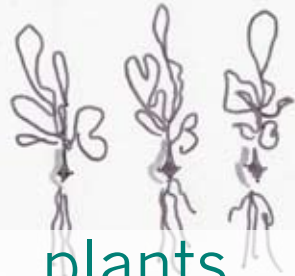

plants



1



clay

2



+ water

3



4

+ straw



5



mold

6



bisque

apply glaze

7



glaze

8

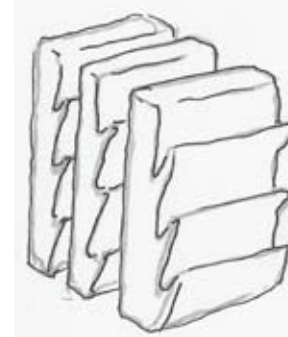

9
insert
in pallets

10

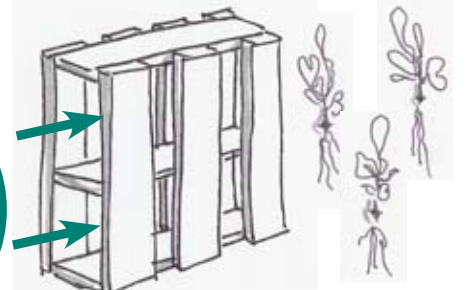

plant

BENEFITS



GROWING MEDIUM



BUILDING MATERIAL



SALABLE GOODS

AGRICULTURAL CERAMICS FOR VERTICAL GARDENING



Community Growing



Colette Bazirgan